

## IMPORTANT SAFETY INSTRUCTIONS

1. Read these instructions.
2. Keep these instructions
3. Heed all warnings.
4. Follow all instructions.
5. Do not use this apparatus near water.
6. Clean only with dry cloth.
7. Install in accordance with the manufacturer's instructions.
8. Do not install near any heat sources such as radiators, heat registers, stoves, or other apparatus that produce heat.
9. Do not defeat the safety purpose of the polarized or grounding-type plug. A polarized plug has two blades with one wider than the other. A grounding-type plug has two blades and a third grounding prong. The wide blade or third prong is provided for your safety. If the provided plug does not fit into your outlet, consult an electrician for replacement of the obsolete outlet.
10. Protect the power cord from being walked on or pinched particularly at plugs, convenience receptacles, and the point where they exit from the apparatus. If the power cord becomes frayed, stop using immediately.
11. Use only attachments/accessories specified by the manufacturer
12. Use only with a cart, stand, tripod, bracket or table specified by the manufacturer, or sold with the apparatus. When a cart is used, use caution when moving the cart/apparatus combination to avoid injury from tip-over.
13. Unplug this apparatus during lightning storms or when unused for long periods of time.
14. Refer all servicing to qualified service personnel. Servicing is required when the apparatus has been damaged in any way, such as power supply cord or plug is damaged, liquid has been spilled or objects have fallen into the apparatus, the apparatus has been exposed to rain or moisture, does not operate normally, or has been dropped.
15. This apparatus shall not be exposed to dripping or splashing, and no object filled with liquids, such as vases, shall be placed on the apparatus.
16. Note that this apparatus is not completely disconnected from the AC mains service when the power switch is in the OFF position.
17. The mains plug or power inlet on the product is used as the disconnect device, so the disconnected device shall remain readily operable when reconnected.
18. Any changes or modifications not expressly approved in this manual could void your authority to operate this apparatus.
19. Only use power supplies and accessories provided with the product or approved by the manufacturer.



The lightning flash with an arrow-head symbol within an equilateral triangle is intended to alert the user to the presence of uninsulated "dangerous voltage" within the product's enclosure that may be of sufficient magnitude to constitute a risk of electric shock

to persons.

The exclamation point within an equilateral triangle is intended to alert the user to the presence of important operating and maintenance (servicing) instructions in the literature accompanying the product.



The Black Lion Audio Revolution 6x6 complies with all applicable RoHS / WEEE European Union directives.

**Do not attempt to service this unit yourself, as it will void your warranty. Please check your unit carefully upon receipt and return to place of purchase immediately if there are any problems with the product. After that, the standard Black Lion Audio 3 YEAR warranty will apply to defects in materials and workmanship.**

### U.S.A.

Should your Black Lion Audio product require service, please contact the Black Lion Audio Service Department: <https://www.blacklionaudio.com/contact>. **You must obtain an RA # (Return Authorization number) from us before shipping a unit back to us. This RA # must be clearly written on the outside of the box.**

**Please safely pack the units...It is best to use the original packing materials. Black Lion Audio cannot be responsible for any damages incurred in shipping to us due to poor packaging. PLEASE PACK CAREFULLY and FULLY INSURE THE SHIPMENT.**

### INTERNATIONAL

For service or warranty assistance, please contact the Black Lion Audio distributor in your country through the dealer from whom you purchased this product.

### LIMITED 3 YEAR WARRANTY

Black Lion Audio's Revolution 6x6 is warranted by Black Lion Audio to be free from defects in materials and workmanship for the period of THREE (3) YEARS to the original purchaser. In the event of such defects, the product will be repaired without charge or, at our option, replaced with a new one if delivered to Black Lion Audio prepaid, together with a copy of the sales slip or other proof of purchase date. The warranty excludes problems due to normal wear, abuse, shipping damage or failure to use the product in accordance with the specifications.

All parts and labor are covered under this Limited Warranty. However, if it is determined by Black Lion Audio that the device was damaged or made defective through abuse, we reserve the right to charge the customer for the cost of the repair.

Black Lion Audio shall not be liable for damages based upon inconvenience, loss of use of the product, loss of time, interrupted operation or commercial loss or any other damages, whether incidental, consequential or otherwise. This warranty gives you specific legal rights, and you may have other rights, which will vary from state to state.

**This warranty is not transferable.**



# Revolution 6x6

6-in / 6-out USB audio interface / word clock / DAC / ADC with USB OTG

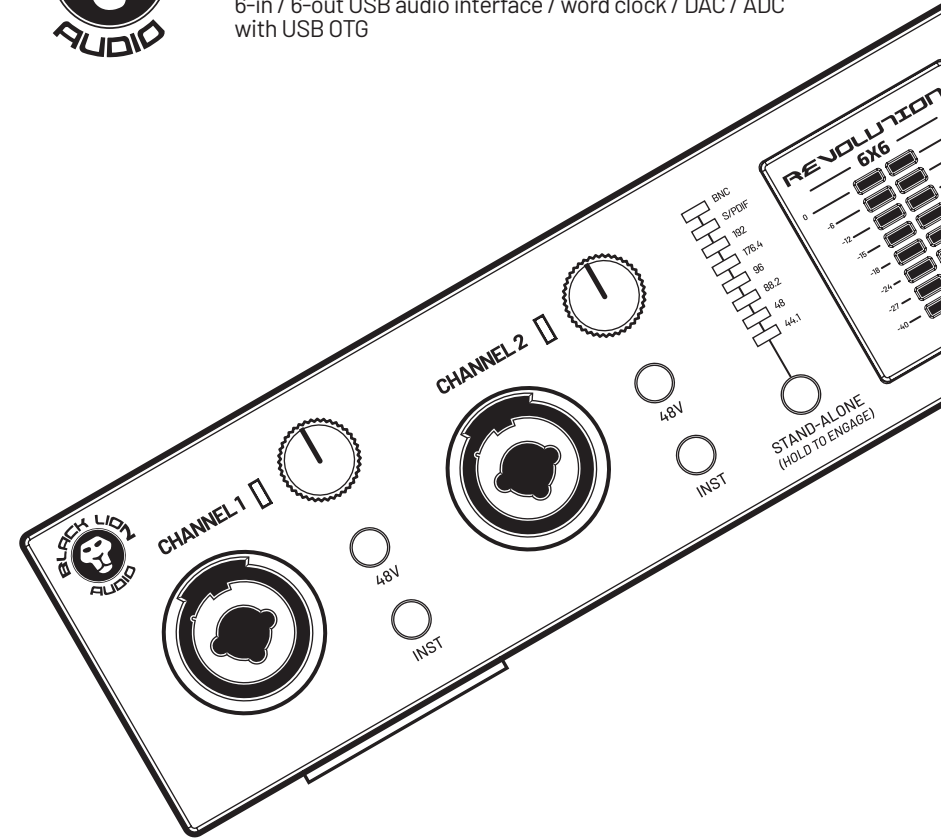

### SOFTWARE REGISTRATION CODE

## Quick Start Guide

RAD Distribution  
180 Carpenter Ave. Middletown,  
New York 10940, US

Revised 07/19/24

## LET'S GET STARTED!

### Product registration and software download instructions

1. Go to [www.blacklionaudio.com](http://www.blacklionaudio.com)
2. Click on the "REGISTER PRODUCT" button on the upper right corner.
3. Click "Create an Account" and follow the on-screen instructions. You'll need to verify your email address once submitted.
4. Return to [blacklionaudio.com](http://blacklionaudio.com) and click on the "REGISTER PRODUCT" button on the upper right corner. Log in to your new account.
5. Click "Register a product" in the blue bar on the top left.
6. Enter serial number of the unit. It's located on the bottom of the unit.
7. Enter software number. It's located on the front cover of this manual.
8. Click "Verify." The following screen will contain your software codes and download instructions.

### Connecting to a Computer (Mac & Windows)

Connect the Revolution 6x6 to your computer using a USB cable. Note: if your Revolution 6x6's USB light does not light green when connecting to a computer, it may be in Standalone mode. Press and hold the Stand-alone button for 5 seconds to switch to interface mode.

**Windows users:** Install the Revolution 6x6 Windows ASIO driver. This installer was designed to be easy to use. Simply follow the on-screen instructions. You will be alerted that the installer has successfully finished and it will prompt you to reboot your computer. Click "Finish" to automatically restart your computer.

**MacOS users:** The Revolution 6x6 is a class-compliant Core Audio device, so no installation is necessary. Simply connect your Revolution 6x6 to your computer to begin using it.

The ASIO drivers are available for download on the [Black Lion Audio website](http://Black Lion Audio website) on the bottom of the Revolution 6x6 page.

### Prepping for Playback

1. Turn the Mixer knob on the front panel of your Revolution 6x6 to the 12 o'clock position. This will allow you to hear both your inputs and the playback from the computer.
2. Connect a pair of headphones to the Revolution 6x6 headphone output and turn the Phones volume control to the 12 o'clock position.

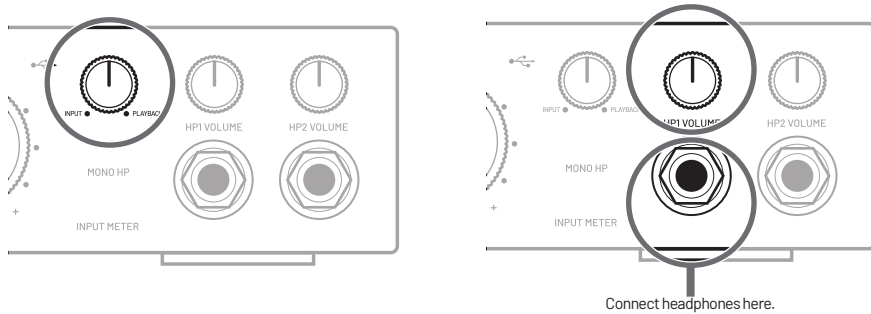

### Recording

1. Connect a microphone then speak into it while watching the input meter in your DAW. Slowly turn the Revolution 6x6's Input 1 Preamp Gain knob clockwise to establish a suitable recording level.
2. Engage MONO button for input monitor summing.
3. Click the "Record" button in your DAW to begin recording your first track!

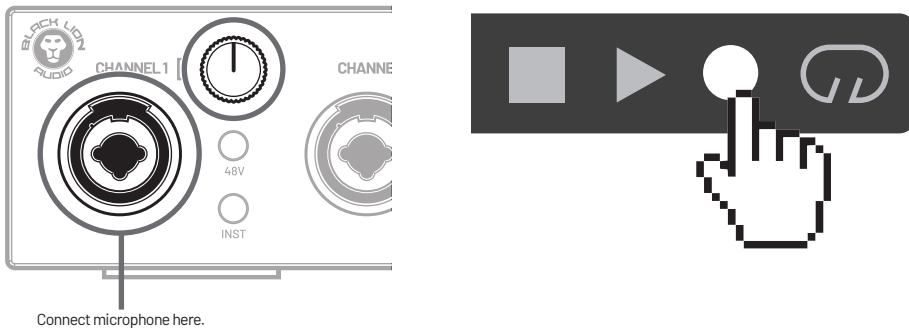

### Advanced Features

More advanced features of the Revolution 6x6 including USB OTG, Standalone mode, and more, are covered in the advanced manual available at [blacklionaudio.com](http://blacklionaudio.com) at the bottom of the Revolution 6x6 page.

## GETTING TO KNOW THE REVOLUTION 6X6.

### Front Panel

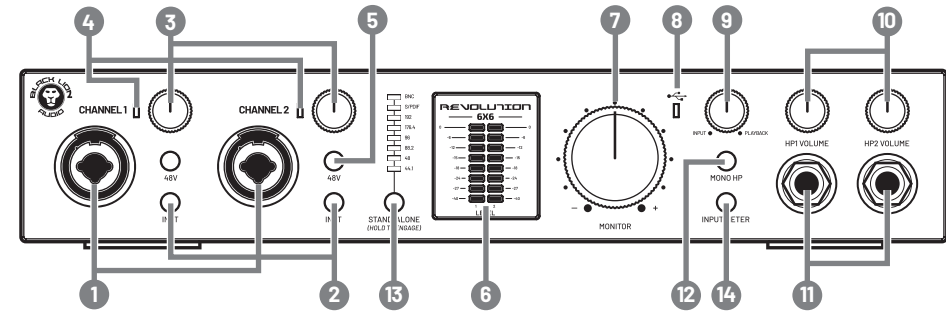

1. **Inputs:** XLR-Combo inputs for connecting microphones, instruments, and line-level equipment. Use the center-balanced 1/4" connection in this jack for line-level and Hi-Z devices (electric guitars and basses.)
2. **Instrument Input Switches:** This selects between unbalanced instrument level and balanced line level for the 1/4" input on the XLR-Combo inputs.
3. **Preamp Gain:** This knob controls gain on the preamplifier.
4. **Input LED:** This LED indicates the levels coming into the interface. Green=signal received; Red=clipping.
5. **48V Buttons:** These buttons turn on 48V phantom power per channel.
6. **Main Meter:** This meters the analog input or playback levels. When set to Input Metering mode, signals hitting 0 dBFS are clipping. S/PDIF and OTG connections are not metered unless in Standalone mode.
7. **Monitor:** This attenuates the monitor output level.
8. **USB Status:** This LED indicates the status of USB connectivity:
  - ▶ **Blinking Red:** Unit is powered on; no secure connection to host via USB or OTG (when not in Standalone mode).
  - ▶ **Solid Red:** OTG Source is connected and secure, but there is no USB source securely connected.
  - ▶ **Solid Yellow:** USB source is connected and has a secure connection to the host AND there is a secure OTG connection as well.
  - ▶ **Solid Green:** USB source is connected and has a secure connection to host.
9. **Direct Mixer:** This knob is a direct mixer for monitoring inputs in real-time. Turn left for analog inputs 1/2, and turn right for playback. When in Standalone Mode the digital inputs (OTG and S/PDIF) can be monitored through the playback setting.
10. **Headphone Volume:** This controls the headphone volume level.
11. **Headphone Output:** Connect your headphones here.
12. **Mono HP:** Engaging this switch performs mono summing of the headphone outputs in Interface mode and both headphone and monitor outputs in Stand-alone mode. For monitoring stereo inputs, make sure this button is disengaged. This button only affects input monitoring, and not playback monitoring.
13. **Stand-Along:** Press and hold to engage Standalone mode to use the Revolution 6x6 without a computer as a primary clock, DAC, or ADC. Press to cycle through available sample rate options. BNC and S/PDIF are external clock input sources for Standalone mode.
14. **Input Meter:** Toggles the Main Meter between displaying analog input or playback levels. Lit=input metering; unlit=playback metering.

### Rear Panel

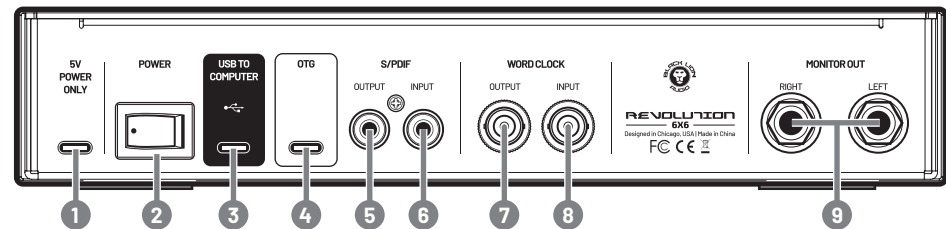

1. **5V Power Connector:** USB-C Connection for power only.
2. **Power Switch:** Turns the unit off or on.
3. **USB-C to Computer:** Connect computer or mobile device here for recording with applications that support multi-channel audio interfaces.
4. **OTG Connector:** Connect devices that support USB OTG (On the Go) here.
5. **S/PDIF Output:** Use this to output mic/inst channels 1 and 2 via a digital S/PDIF connection to another device.
6. **S/PDIF Input:** Connect S/PDIF digital outputs from devices here.
7. **Word Clock Output:** Use this to use the Revolution 6x6 as a primary clock for your other devices.
8. **Word Clock Input:** Use this to sync Revolution 6x6 to your primary clock when in standalone mode.
9. **Monitor Output:** Main outputs. Connect your monitor speakers here.

**A note on the power supply:** While Revolution 6x6 can be run over bus power via the USB connection, we recommend using the included power supply to use the headphones at full volume or standalone mode. When connecting to AC power using the included power supply, use one of the included USB cables for power and the other for your computer connection.

**A note on USB OTG:** USB OTG (On-the-go) allows you to connect a mobile USB device to the Revolution 6x6 and send audio to and from the device. Sample from your phone to your laptop, or livestream a laptop session from your phone! The OTG port does not facilitate power to or from the mobile device. iPhone models prior to iPhone 15 will require a lightning-to-USB OTG adapter.